



COOK

PLC12

DATE: _____
 PROJECT: _____
 LOCATION: _____



**Centrifugal Plenum Fan
 Arrangement 3
 12 Float Wheel**

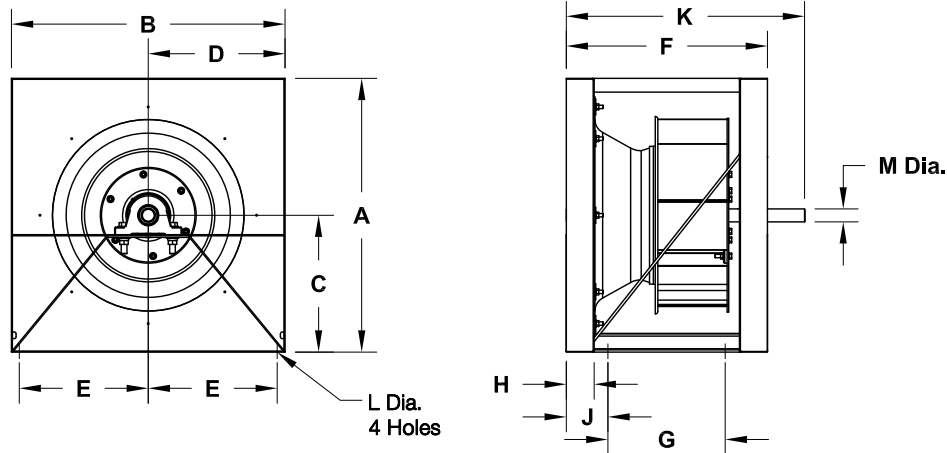

DIMENSION DATA

Size	A	B	C	D	E			F			G			H		
					Class I	Class II	Class III	Class I	Class II	Class III	Class I	Class II	Class III	Class I	Class II	Class III
120	17-1/4	17-1/4	8-5/8	8-5/8	7-11/16	7-11/16	-	13-1/16	13-1/16	-	7-7/16	7-7/16	-	1-13/16	1-13/16	-
135	19-1/2	19-1/2	9-3/4	9-3/4	8-13/16	8-13/16	-	14-5/8	14-5/8	-	8-1/2	8-1/2	-	2-1/16	2-1/16	-
150	21-1/2	21-1/2	10-3/4	10-3/4	9-13/16	9-13/16	-	15-9/16	15-9/16	-	9-7/16	9-7/16	-	2-1/16	2-1/16	-
165	23-3/4	23-3/4	11-7/8	11-7/8	10-15/16	10-15/16	-	16-3/4	16-3/4	-	10-5/8	10-5/8	-	2-1/16	2-1/16	-
180	25-3/4	25-3/4	12-7/8	12-7/8	12	12	11-9/16	19-7/8	19-7/8	20-15/16	11-3/4	11-3/4	10-3/4	3-1/16	3-1/16	3-1/16
195	28	28	14	14	13-1/8	13-1/8	12-11/16	21	21	22-1/16	12-7/8	12-7/8	11-7/8	3-1/16	3-1/16	3-1/16
210	30	30	15	15	14-1/8	14-1/8	13-11/16	22-1/16	22-1/16	23-1/8	13-15/16	13-15/16	12-15/16	3-1/16	3-1/16	3-1/16
225	32-1/4	32-1/4	16-1/8	16-1/8	15-1/4	15-5/16	14-13/16	23-1/16	23-1/16	24-1/8	14-15/16	14-15/16	13-15/16	3-1/16	3-1/16	3-1/16
245	35	35	17-1/2	17-1/2	16-3/8	16-7/16	16-3/16	24-1/2	24-1/2	25-9/16	15-7/8	15-7/8	15-3/8	3-1/16	3-1/16	3-1/16
270	38-3/4	38-3/4	19-3/8	19-3/8	18-1/4	18-5/16	18-1/16	27-7/16	27-7/16	29	17-13/16	17-13/16	17-5/16	3-9/16	3-9/16	3-9/16
300	43	43	21-1/2	21-1/2	20-3/16	20-3/16	20-3/16	29-1/2	29-1/2	31-1/16	19-3/8	19-3/8	19-3/8	3-9/16	3-9/16	3-9/16
330	49-1/2	49	23-5/8	23	22-5/16	22-1/4	22-1/4	32-3/16	34-3/16	34-3/16	26-3/8	27-3/8	27-3/8	3-9/16	4-9/16	4-9/16
365	53-1/2	49	26-1/8	24-1/2	23-13/16	23-3/4	23-3/4	34-9/16	36-5/8	36-5/8	28-3/4	29-13/16	29-13/16	3-9/16	4-9/16	4-9/16
402	60	54	28-3/4	27	26-1/4	26-1/8	26-1/8	39-7/16	40-15/16	41	32-5/8	33-5/8	33-5/8	4-9/16	5-1/16	5-1/8
445	64	58-1/2	31-7/8	29-1/4	28-1/2	28-3/8	28-3/8	43	45	45	35-5/8	36-5/8	36-5/8	5-1/8	6-1/8	6-1/8
490	70	63	35	31-1/2	30-5/8	30-1/2	30-1/2	47-1/4	50-11/16	50-11/16	39-7/8	41-7/8	41-7/8	5-1/8	6-9/16	6-9/16
540	75	69	38-5/8	34-1/2	33-5/8	33-1/2	33-1/2	50-7/8	54-3/8	54-3/8	43-1/2	45-1/2	45-1/2	5-1/8	6-5/8	6-5/8
600	82	75	42-7/8	37-1/2	36-5/8	36-1/2	36-1/2	56-1/4	59-1/4	59-1/4	47-7/8	49-7/8	49-7/8	6-1/8	7-1/8	7-1/8
660	90	82	47-1/4	41	40	39-11/16	39-11/16	63-11/16	64-11/16	64-11/16	54-5/16	54-5/16	54-5/16	7-1/8	8-1/8	8-1/8
730	92	92	52-1/4	46	45	44-11/16	44-11/16	69-11/16	69-3/4	69-3/4	59-5/16	59-3/8	59-3/8	8-1/8	8-1/8	8-1/8

Size	J			K			L			M			Shipping Weights		
	Class I	Class II	Class III	Class I	Class II	Class III	Class I	Class II	Class III	Class I	Class II	Class III	Class I	Class II	Class III
120	2-13/16	2-13/16	-	16-15/16	17-5/16	-	5/8	5/8	-	1-3/16	1-7/16	-	114	118	-
135	3-1/16	3-1/16	-	18-1/2	18-7/8	-	5/8	5/8	-	1-3/16	1-7/16	-	129	134	-
150	3-1/16	3-1/16	-	19-1/2	19-7/8	-	5/8	5/8	-	1-3/16	1-7/16	-	141	147	-
165	3-1/16	3-1/16	-	20-11/16	21-1/16	-	5/8	5/8	-	1-3/16	1-7/16	-	162	165	-
180	4-1/16	4-1/16	4-9/16	24-1/16	24-3/16	25-11/16	5/8	5/8	5/8	1-7/16	1-7/16	1-15/16	212	212	247
195	4-1/16	4-1/16	4-9/16	25-1/8	25-1/4	26-15/16	5/8	5/8	5/8	1-7/16	1-7/16	1-15/16	230	234	281
210	4-1/16	4-1/16	4-9/16	26-3/16	26-7/16	28	5/8	5/8	5/8	1-7/16	1-7/16	1-15/16	248	254	305
225	4-1/16	4-1/16	4-9/16	27-3/16	27-7/16	29-1/8	5/8	5/8	5/8	1-7/16	1-11/16	1-15/16	277	295	337
245	4-5/16	4-5/16	4-9/16	28-13/16	29-1/16	30-9/16	5/8	5/8	5/8	1-7/16	1-15/16	2-3/16	343	381	378
270	4-13/16	4-13/16	4-13/16	31-11/16	32-1/16	34-1/4	5/8	5/8	5/8	1-7/16	1-15/16	2-7/16	423	460	465
300	5-1/16	5-1/16	5-1/16	33-15/16	34-5/16	36-9/16	5/8	5/8	5/8	1-11/16	2-3/16	2-7/16	529	571	573
330	4-11/16	5-11/16	5-11/16	36-13/16	39-1/16	39-13/16	15/16	15/16	15/16	1-15/16	2-3/16	2-7/16	608	639	691
365	4-11/16	5-11/16	5-11/16	39-3/8	41-5/8	42-1/2	15/16	15/16	15/16	1-15/16	2-3/16	2-11/16	662	725	823
402	5-11/16	6-3/16	6-1/4	44-7/16	46-1/4	47-3/8	15/16	15/16	15/16	2-7/16	2-3/16	2-15/16	972	972	1141
445	6-1/4	7-1/4	7-1/4	48-1/8	50-3/4	51-7/8	15/16	15/16	15/16	2-7/16	2-7/16	3-7/16	1231	1265	1472
490	6-1/4	7-11/16	7-11/16	52-5/8	56-13/16	58-1/16	15/16	1-1/16	1-1/16	2-7/16	2-11/16	3-7/16	1515	1618	1771
540	6-1/4	7-3/4	7-3/4	56-1/2	61	62-3/8	1-1/16	1-1/16	1-1/16	2-7/16	2-15/16	3-7/16	1626	1809	1919
600	7-1/4	8-1/4	8-1/4	62-1/4	66-5/8	68-1/8	1-1/16	1-1/16	1-1/16	2-11/16	3-7/16	3-15/16	2057	2276	2517
660	8-1/4	9-1/4	9-1/4	70-5/16	72-13/16	74-7/16	1-1/16	1-1/16	1-1/16	2-15/16	3-7/16	3-15/16	2622	2883	3291
730	9-1/4	9-1/4	9-1/4	76-15/16	78-7/8	80-5/8	1-1/16	1-1/16	1-1/16	3-7/16	3-7/16	4-7/16	3203	3323	3980

ALL DIMENSIONS IN INCHES. WEIGHTS IN LBS., LESS MOTOR.

PL005R00